

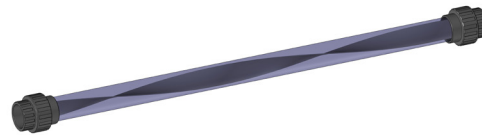

# SPIROMIX TUBE

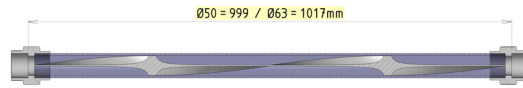
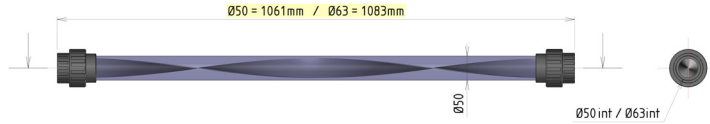

SKIOLD MAKES THE DIFFERENCE!

## TECHNICAL INFORMATION:

| Item numbers                | 150 000 105 013  | 150 000 105 014                 |
|-----------------------------|--|---------------------------------|
| Item text                   | Spiromix tube PVC Ø50 PN10 cpl.  | Spiromix tube PVC Ø63 PN10 cpl. |
| L x W x H                   | 1061 x 78 x 78 mm  | 1083 x 95 x 95 mm               |
| Build-in length             | 999 mm   | 1017 mm                         |
| Transportweight             | 1,8 kg   | 2,3 kg                          |
| Flowspeed                   | 1 - 8 kg/s   | 1 - 8 kg/s                      |
| Temperature Range           | 4 - 50° C  | 4 - 50° C                       |
| Pressure Range (feed)       | 2 - 4 bar  | 2 - 4 bar                       |
| Connections                 | Ø50 mm feeding tube  | Ø63 mm feeding tube             |
| Material (Tubes and Unions) | PVC  | PVC                             |
| Material (Liner)            | Stainless Steel (AISI 304)   | Stainless Steel (AISI 304)      |
| Placement                   | 1 pcs. "spiromix" for every app. 50 m on longer, straight pipelines (not on the first app. 50 m after the feedpump, or on the first app. 15 m after corners).<br>By strongly seperative feedsorts they must be placed at a shorter interval. |                                 |